

JMB's Turn and Lock™ Blade Connection System: - Remove and replace a blade

The JMB Turn and Lock™ post connection system is designed to deliver a post connection system that allows Spring Return Posts to be quickly removed and replaced from the ground connection option. The Turn and Lock System is totally interchangeable throughout the Generation 2 Turn and Lock™ suite of products as seen in Figure 1.

1) Safety

Always use traffic control appropriate to the location to make the work area safe for installation

2) Turn and Lock Connection Posts and Bases are Completely Interchangeable

Figure 1 shows a snapshot of the Turn and Lock™ range of posts and ground connection options. Any post type in the picture can be fitted into any of the ground connection options.

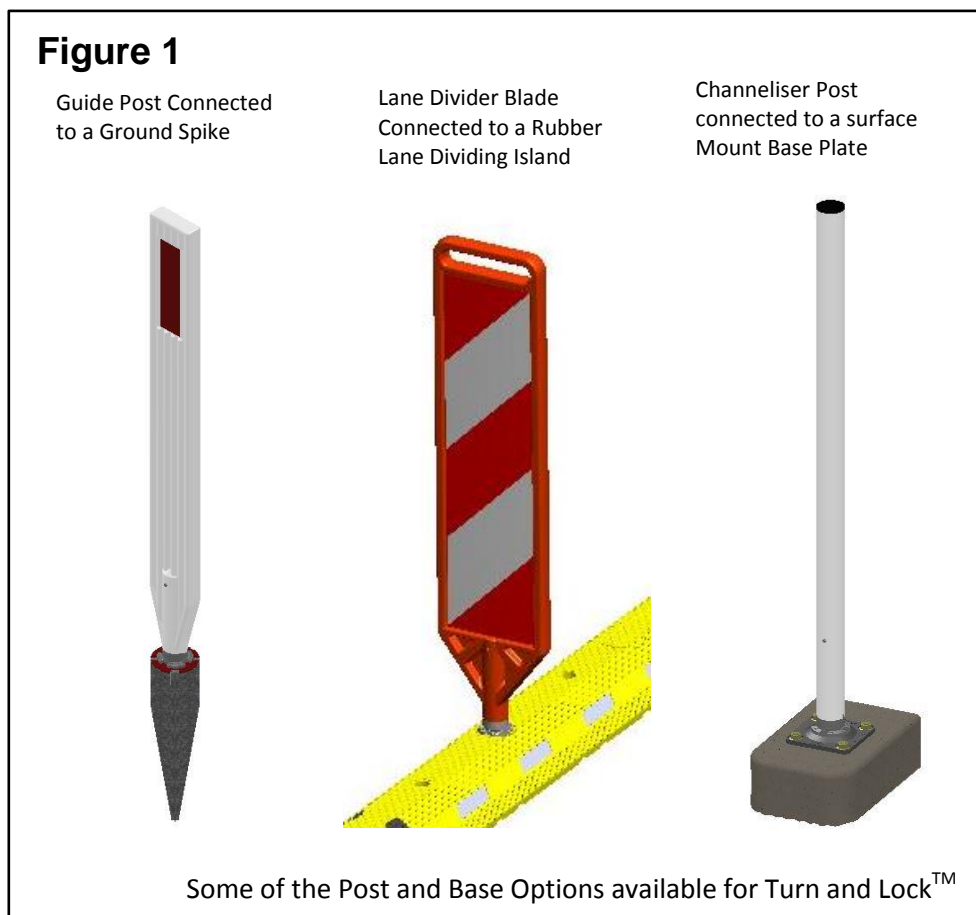

3) Blade and Divider Island Set Shown

For this information sheet a Lane Divider Blade and Rubber Divider combination have been pictured. However the steps shown to remove and replace all Turn and Lock™ posts are identical for any post, blade and base combination within the range.

JMB's Turn and Lock™ Blade Connection System: - Remove and replace a blade cont.

4) Removing a Turn and Lock™ Blade

Both Installation and replacement of blades only takes seconds. Refer to the following Figures 2 to 4 below.

Figure 2: Step 1

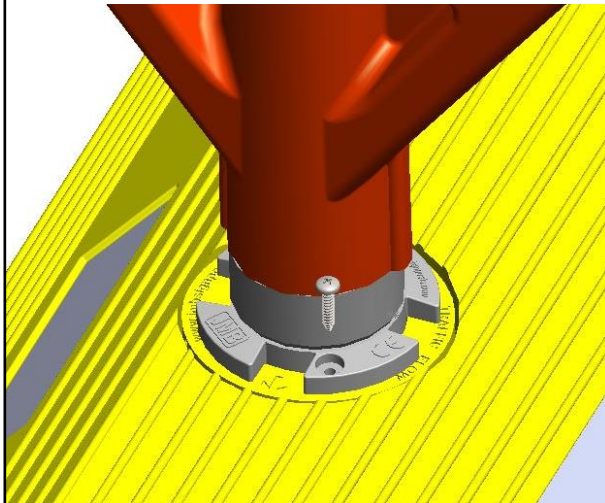

Remove the locking Screw or Pin (if fitted)
Screw: Pan Head 6g x 16mm or 7g x 16mm
Pin: 3mmOD x 12mm (minimum)

Figure 3: Step 2

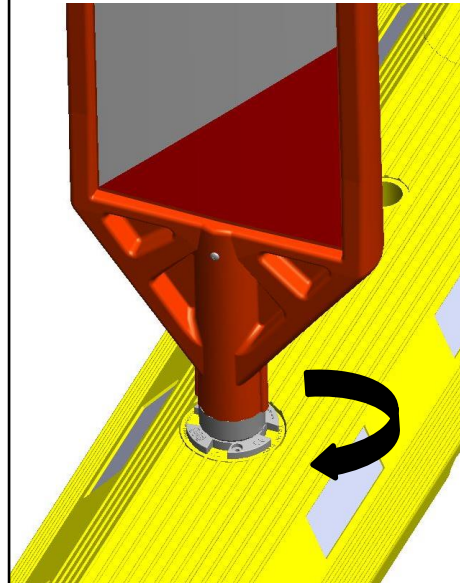

Turn the blade clockwise to unlock.

Figure 4: Step 3

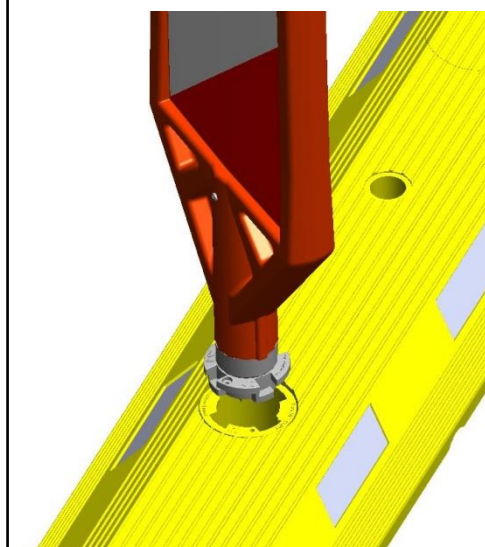

Lift the blade out of the base

JMB's Turn and Lock™ Blade Connection System: - Remove and replace a blade cont.

5) Installing a Turn and Lock™ Blade

Both Installation and replacement of blades only takes seconds.

The "Turn and Lock" system is keyed to ensure the correct post orientation. A locking screw or pin can be used to prevent accidental disconnection. Refer to the following Figures 5 to 8 below.

Figure 5: Step 1

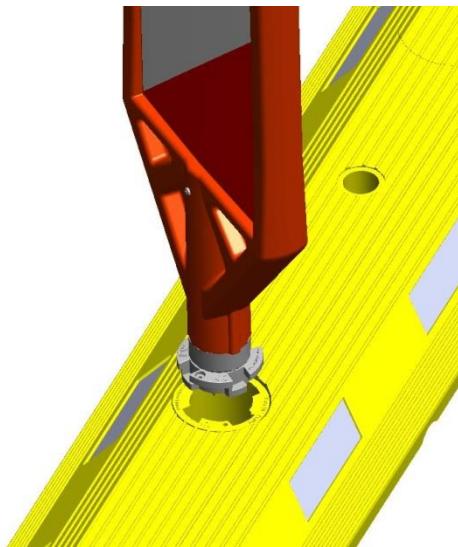

Position the Blade Above the insert point aligning the locating peg

Figure 6: Step 2

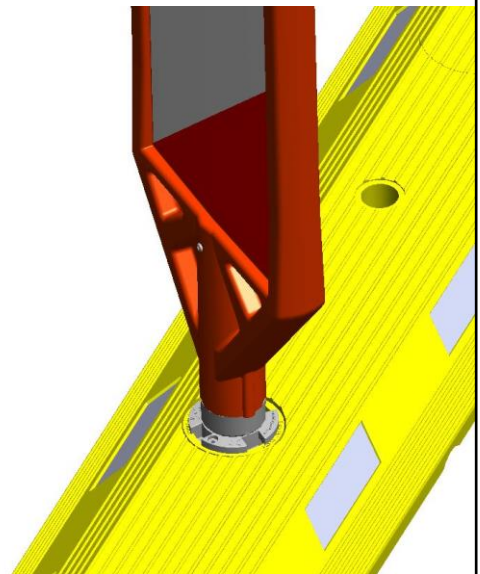

Insert into the hole

Figure 7: Step 3

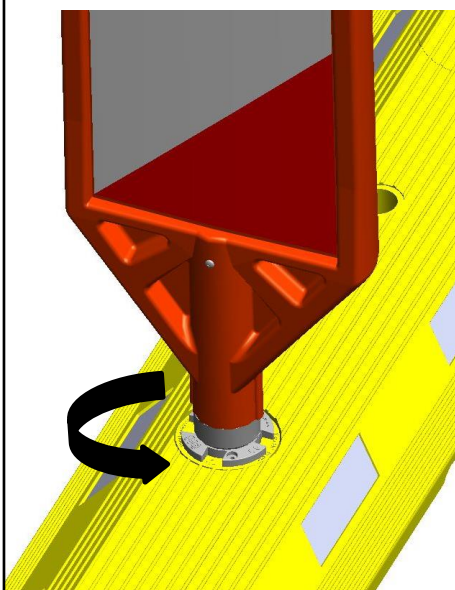

Turn the blade and lock.

Figure 8: Step 4

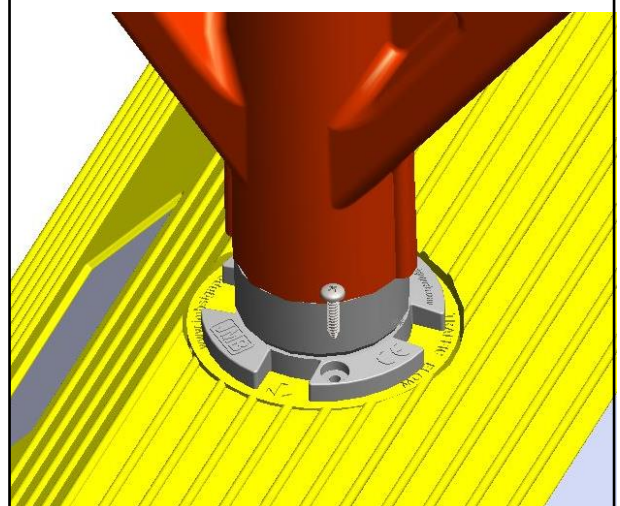

Fit a locking Screw or Pin (*optional*)
Screw: Pan Head 6g x 16mm or 7g x 16mm
Pin: 3mmOD x 12mm (*minimum*)

REFERENCE INFORMATION:

Other general Installation and Dimensional information is available for download off the JMB website Technical Information page